



Aluminium  
joinery throughout  
each cabin

Sold and delivered as  
Flat pack Kit-Set

# Kowhai Log Cabin

Floor Area: 28m<sup>2</sup>

Wall Thickness: 47mm

(L) 7m x (W) 4m x (H) 3.071m

## Specifications

Model	Kowhai
Colour	Natural
Material	FSC Certified Slow Grown Scots Pine
Roof Style	Apex
Gross Weight	2600kg
Footprint Dimensions	(L) 7 x (W) 4m
Footprint Size	28sqms
Net Floor Area	23.07sqms
Overhang Dimensions	Front overhang 500mm, other sides 300mm
Ridge Height	3.071m (Including Joist)
Eaves Height	2.598m (Including Joist)
Max Ceiling (Internal) Height	2.885m (Floor to Ceiling, Excluding Rafters)
Min Ceiling (Internal) Height	2.412m (Floor to Ceiling, Excluding Rafters)
Wall Thickness	47mm
Floor Thickness	18mm
Roof Thickness	18mm
Floor Beams	47 x 145mm
Roof Material	Premium asphalt shingles
Aluminium Window	(W) 1.126 x (H) 0.976m
Aluminium Window	(W) 0.727 x (H) 0.566m
Aluminium Door	(W) 1.326 x (H) 2.074m
Wooden Door	(W) 0.84 x (H) 2.001m
Wooden Door	(W) 0.68 x (H) 2.001m

### Glass

5mm Double-glazed Toughened Glass

### Kit-Set Contents

Roof, roof beams, fascia boards, walls, floor, floor beams, aluminium door, asphalt shingles, building wrap, assembling accessories kit.

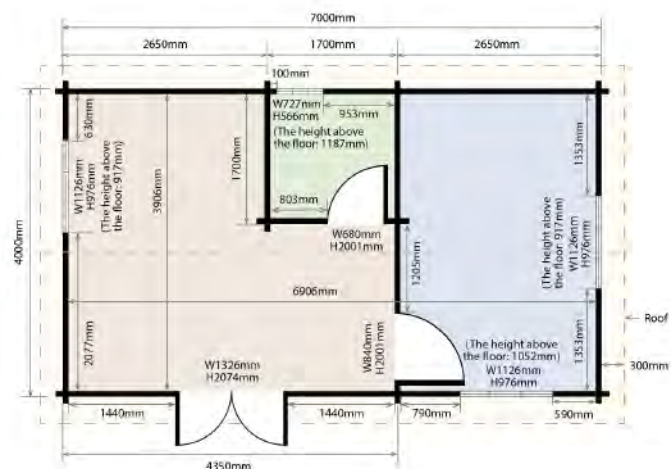

Max Ceiling (Internal) Height: 2885mm  
Min Ceiling (Internal) Height: 2412mm  
\* Floor to Ceiling (Excluding Rafters)

As life changes we all need extra space. The Kowhai all timber cabin provides an attractive sustainable solution.

If you are looking to create a truly beautiful space for almost any purpose you choose, the Kowhai does this so well. Be it an workshop, art studio, craft room, home office or simply extra space. Potential applications are endless.

The cabin's doors and windows are positioned to allow for plenty of natural light, allowing you to work, relax and craft in comfort. The aluminium doors and windows are double-glazed with toughened glass. They are secured with tough stainless steel hardware.



Made from kiln-dried FSC certified chemical free Scots pine. The walls are tongue and groove solid 47mm thick timber. This provides natural insulation and strength.

The floor and roof are tongue and groove 18mm Scots pine, completing the all round solid timber look.

## Features

- Constructed from kiln dried, FSC Certified chemical free Scots pine
- Aluminium joinery provided standard on all cabins
- Double-glazed doors and windows (Toughened glass standard)
- Arrives unfinished – It is important to oil, or paint after assembly
- Tongue and groove construction for durability and stability
- 47mm solid timber walls
- Rooms designed to let in natural light
- Asphalt roof shingles
- Stainless steel fittings
- 5 year manufacturer's warranty

## Foundation and Site Information

The cabin must be built on a completely level surface. Lifestyle Cabins recommends pile foundations. A poured concrete slab is also suitable. Other options are available so you should discuss this with a local builder to see what is suitable in your area.



Footprint Size: 28m<sup>2</sup>  
Net Floor Area: 26.97m<sup>2</sup>



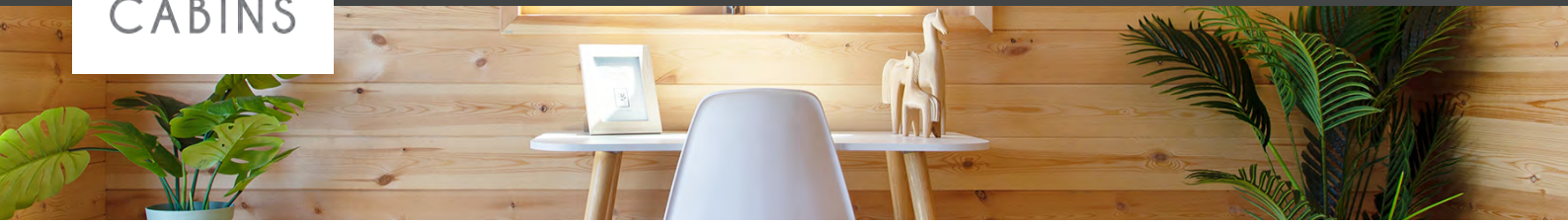

Lifestyle Cabins are supplied in kitset form. They come with a full set of assembly instructions and all of the fittings and fixtures.

It is important to note that assembling one of our cabins is not something you should attempt if you have no building or practical experience or inadequate tools. The assembling and understanding of the instruction manual can be quite confusing for the inexperienced.

You must allow sufficient time, assistance, and resource to complete the job properly.

If you choose this option it can be very fulfilling as many of our customers tell us that assembling one of these cabins is one of the more satisfying things they have done.

Most of our customers DIY these cabins themselves.

If you feel this is not a job that you want to tackle yourself then it is best to arrange for a contractor to complete it for you. Any skilled handyman or builder is able to complete this project.

Lifestyle Cabins is happy to put you in touch with a contractor if we are familiar with any in your area.

## Extras

### Electrical

Lifestyle Cabins are straightforward to add lights, power outlets etc. We recommend wooden capping to keep with the wooden rustic appearance of the cabin. Any qualified electrician is able to complete this for you.

### Underfloor insulation, roof insulation, decking, etc.

All are possible. Simply DIY or ask your contractor to discuss directly. Be sure to check with the local regulations if there are any restrictions in your area.

## Delivery

Delivery cost varies with location and ease of access to your site. Please contact us and we'll give you a competitive price for delivery. Please note a site inspection may be required.

## What happens now?

Call or email us today to secure your cabin.

 0800 997 735

 [sales@lifestylecabins.co.nz](mailto:sales@lifestylecabins.co.nz)



NZ wide delivery, with most cabins in stock and ready to be shipped to you.

Don't delay, order your cabin today. Our prices are unbeatable and our quality is excellent. You will never regret an investment in one of these cabins.